

6 5 4 3 2 1

D

D

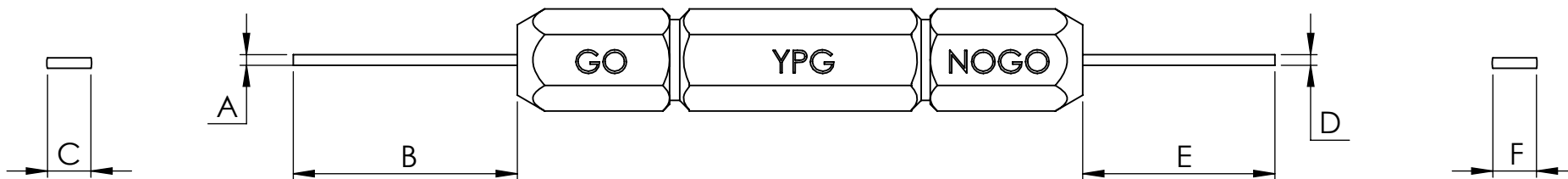

C

C

Pin diameter range 0.2 – 19.45mm				-standard	
A (GO seg)	B (GO protrusion)	C (GO diameter)	D (NOGO seg)	E (NOGO protrusion)	F (NOGO diameter)
	35mm			30mm	

B

B



A

A

DIMENSIONS ARE IN MILLIMETERS		
	NAME	DATE
DRAWN	D.Fletcher	28/03/2019
TITLE:	Full length parallel segmented	
MATERIAL:	TOOL STEEL	

Yorkshire Precision Gauges
Hatfield
Doncaster
England
DN7 6QF



DWG. NO.
FLPS-001

t: +44 (0)1302 840 303
f: +44 (0)1302 843 570
Gauges@ypg.co.uk
<http://www.ypg.co.uk/>

SCALE: 1:1

SHEET 1 OF 1

6 5 4 3 2 1